

DRAPER®

INSTRUCTIONS FOR Steel Workbench

Stock No.40909

Part No.WB1530

IMPORTANT: PLEASE READ THESE INSTRUCTIONS CAREFULLY TO ENSURE THE SAFE AND EFFECTIVE USE OF THIS PRODUCT.



DRAPER®

GENERAL INFORMATION

Read all these instructions before operating this product and save these instructions.

This manual has been compiled by Draper Tools and is an integrated part of the product with which it is enclosed and should be kept with it for future references.

This manual describes the purpose for which the product has been designed and contains all the necessary information to ensure its correct and safe use. We recommend that this manual is read before any operation or, before performing any kind of adjustment to the product and prior to any maintenance tasks. By following all the general safety instructions contained in this manual, it will ensure both product and operator safety, together with longer life of the product itself.

All photographs and drawings in this manual are supplied by Draper Tools to help illustrate the operation of the product.

Whilst every effort has been made to ensure accuracy of information contained in this manual, the Draper Tools policy of continuous improvement determines the right to make modifications without prior warning.



CONTENTS

Contents/Specification 1

Guarantee 2

Safety Instructions for Steel Workbenches / Maintenance 3

Getting to Know Your Workbench 4

Assembly 5-6



SPECIFICATION

The Draper Tools policy of continuous improvement determines the right to change specification without notice.

Stock No. 40909

Part No. WB1530

Length 1530mm

Width 705mm

Maximum height 865mm

Drawer depths 60/105mm

Drawer width 620mm

Maximum bench surface weight limit 450kgs

Maximum weight limit for each drawer 15kgs

- Dimensions can vary during production.



GUARANTEE

Draper tools have been carefully tested and inspected before shipment and are guaranteed to be free from defective materials and workmanship.

Should the tool develop a fault, please return the complete tool to your nearest distributor or contact Draper Tools Limited, Chandler's Ford, Eastleigh, Hampshire, SO53 1YF, England. Telephone: (023) 8026 6355.

A proof of purchase must be provided with the tool.

If upon inspection it is found that the fault occurring is due to defective materials or workmanship, repairs will be carried out free of charge. This guarantee period covering parts/labour is 12 months from the date of purchase. This guarantee does not apply to normal wear and tear, nor does it cover any damage caused by misuse, careless or unsafe handling, alterations, accidents, or repairs attempted or made by any personnel other than the authorised Draper warranty repair agent.

Note: If the tool is found not to be within the terms of warranty, repairs and carriage charges will be quoted and made accordingly.

This guarantee applies in lieu of any other guarantee expressed or implied and variations of its terms are not authorised.

Your Draper guarantee is not effective unless you can produce upon request a dated receipt or invoice to verify your proof of purchase within the guarantee period.

Please note that this guarantee is an additional benefit and does not affect your statutory rights. Draper Tools Limited.

Note: This tool is intended for domestic use only.

SAFETY INSTRUCTIONS FOR STEEL WORKBENCHES

WARNING:

Please read the following instructions carefully, failure to do so could lead to serious personal injury. Read all these instructions before operating this product and save these instructions.

IMPORTANT:

Draper Tools Limited recommends that this workbench should not be modified or used for any application other than that for which it was designed.

1. Use adequate manpower when assembling and moving this unit. Failure to do so may cause personal injury or product damage.
2. **DO NOT** stand on this product, you may fall which may cause personal injury.
3. **DO NOT** mount this product on a truck bed or any other moving object. This may cause personal injury or product damage.
4. **DO NOT** move this product with a forklift.
5. **DO NOT** alter this product in any manner. This may cause product damage or personal injury.
6. Keep the product on level surfaces. The product may become unstable and tip if stored or moved on an unlevel surface, which may cause personal injury or product damage.
7. Be sure to secure the unit to a studed or concrete wall. Failure to do so may cause the unit to become unstable & tip. This may cause personal injury or product damage.
8. Maximum combined weight limit not to exceed 450kgs. If the limit is exceeded, the product could collapse and cause personal injury or product damage.
9. Maximum weight limit for each drawer should be no more than 15kgs.

MAINTENANCE

- Lubricate the slides with grease or equivalent, every six months.
- Periodically the drawer fronts, drawer trim and other surfaces should be wiped clean with a mild soap and water. Do not soak bench as this may lead to the worktop swelling or the metal components rusting.

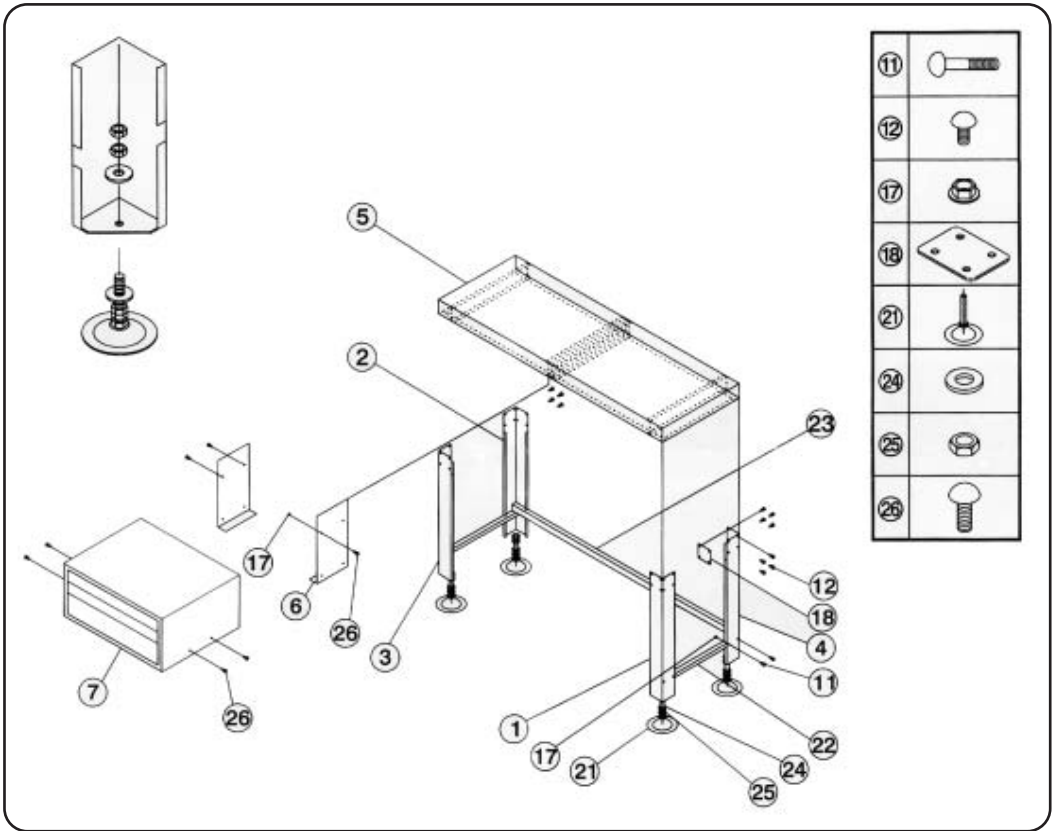

- | | | | |
|----|---|----|--|
| ① | 1 x Front-right angle frame. | ①⑦ | 16 x M8 Lock nut. |
| ② | 1 x Back-left angle frame. | ①⑧ | 8 x M8 Fixed metal plate with hole. |
| ③ | 1 x Front-left angle frame. | ②① | 4 x Adjusting device. |
| ④ | 1 x Back-right angle frame. | ②② | 2 x Short square bar. |
| ⑤ | 1 x Table. | ②③ | 1 x Long square bar. |
| ⑥ | 2 x Drawer brackets (sold separately). | ②④ | 8 x 1/2" Washer. |
| ⑦ | 1 x 3 Drawer chest (sold separately). | ②⑤ | 16 x 1/2" Hexagon nut. |
| ①① | 12 x M8* 45mm Button head socket screw. | ②⑥ | 8 x M8* 15mm Button head socket screw. |
| ①② | 32 x M8* 12mm Button head socket screw. | | |

- **UNPACKING:** After removing the packing material, make sure the product is in perfect condition and that there are no visible damaged parts. If in doubt, do not use the product and contact the dealer from whom it was purchased.

The packaging materials (plastic bags, polystyrene, etc.), must be disposed of in an appropriate refuse collection container. These materials must not be left within the reach of children as they are potential sources of danger.

Tools required for assembly:

- Rubber mallet.
 - 6mm Hexagon key.
 - 12mm Spanner.
- (Tools not included).

STEP 1 (Fig.1):

Using (24) 1/2" washers and (25) 1/2" hexagon nuts to attach (21) adjusting devices with screws under (1), (2), (3), (4), angle frames, all the adjusting devices are with 4 pieces (25) 1/2" hexagon nut and 2 pieces (24) 1/2" washers.

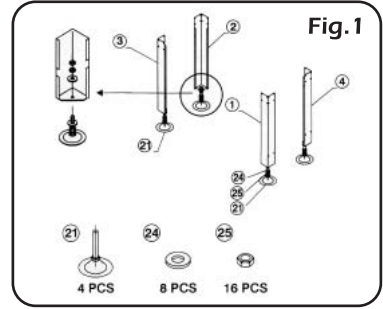

STEP 2 (Fig.2):

- Using (11) M8* 45mm button head socket screws and (17) M8 lock nut to attach (22) short square bar to (1), (4) angle frames.
- Do not over tighten these screws and nuts.

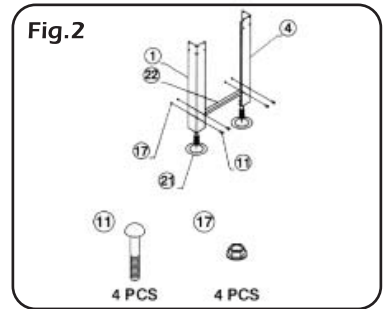

STEP 3 (Fig.3):

- Using (11) M8* 45mm button head socket screws and (17) M8 lock nut to attach (22) short square bar to (2), (3) angle frames.
- Do not over tighten these screws and nuts.

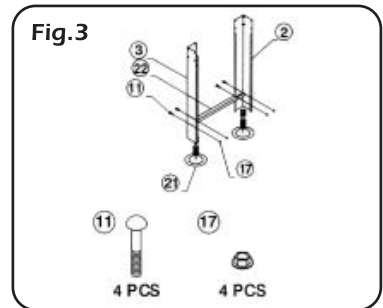

STEP 4 (Fig.4):

- Using (11) M8* 45mm button head socket screws and (17) M8 lock nut to attach (23) long square bar to (2), (4) angle frames.
- Do not over tighten these screws and nuts.

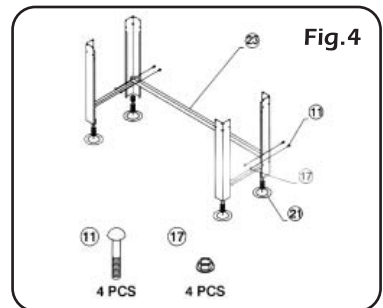

STEP 5 (Fig.5):

- Put the (5) table on the inside of (1), (2), (3), (4) angle frame, using (12) M8* 12mm button head socket screws and (18) M8 fixed metal plate to attach (5) table, (8) back panel angle frames and (2), (4) angle frames.

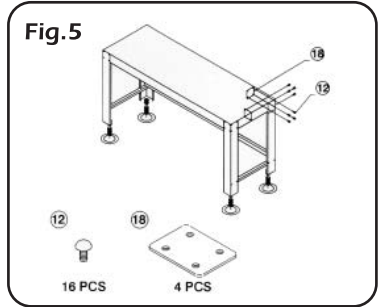

STEP 6 (Fig.6):

- Using (12) M8* 12mm button head socket screws and (18) M8 fixed metal plate to attach (5) table.
- Tie up (12) M8* 12mm button head socket screws and (18) M8 fixed metal plate.
- Tie up (11) M8* 45mm button head socket screws and (17) lock nuts.
- Ensure all nuts and bolts are now tightened.

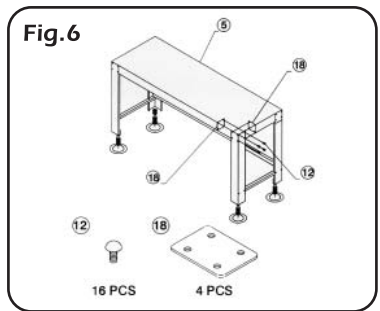

STEP 7 OPTIONAL TOOL BOX (Fig.7):

- Using (26) M8* 15mm button head socket screws and (17) lock nut to attach (6) drawer brackets (sold separately) under (5) table.
- Drawer brackets, Stock no.40910.
- 3 Drawer tool box, Stock no.78222.

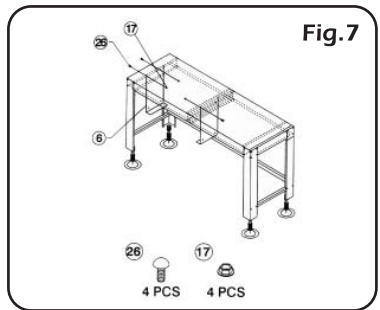

STEP 8 (Fig.8):

- Put (7) 3 drawer chest into the (6) drawer brackets, using (26) M8* 15mm button head socket screws to tie up the (6) connecting panel and (7) 3 drawer chest.

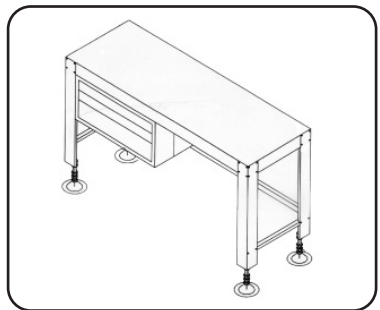
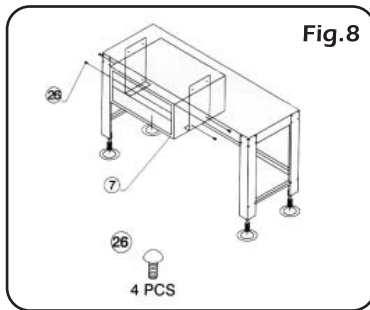

- **DRAPER TOOLS LIMITED,**
Hursley Road, Chandler's Ford,
Eastleigh, Hampshire. SO53 1YF. U.K.

- **Helpline:** (023) 8049 4344
- **Sales Desk:** (023) 8049 4333
- **General Enquiries:** (023) 8026 6355
- **Fax:** (023) 8026 0784
- **Internet:** www.draper.co.uk
- **E-mail:** sales@drapertools.com

- **Service/Warranty Repair Agent**
For aftersales servicing or warranty repairs, please
contact the Draper Tools Helpline for details of an
agent in your local area.

YOUR DRAPER STOCKIST

RWDP231006