



INSTRUCTIONS FOR: JANITORIAL/HOUSEKEEPING CART MODEL NO: BM32

Thank you for purchasing a Sealey product. Manufactured to a high standard this product will, if used according to these instructions and properly maintained, give you years of trouble free performance.



IMPORTANT: READ THESE INSTRUCTIONS CAREFULLY. NOTE THE SAFE OPERATIONAL REQUIREMENTS, WARNINGS AND CAUTIONS. USE THIS TROLLEY CORRECTLY AND WITH CARE FOR THE PURPOSE FOR WHICH IT IS INTENDED. FAILURE TO DO SO MAY CAUSE DAMAGE OR PERSONAL INJURY AND WILL INVALIDATE THE WARRANTY. RETAIN THESE INSTRUCTIONS FOR FUTURE USE.

1. SAFETY INSTRUCTIONS

1.1. GENERAL SAFETY

- WARNING! Ensure Health & Safety, local authority, and general workshop practice regulations are adhered to when using this trolley.**
- x **DO NOT** overload the trolley.
- x **DO NOT** drop loads on to shelves.
- x **DO NOT** place hot (above 100°C) items on to shelves.
- ✓ Load shelves with the heaviest items on the lower shelves.
- ✓ Use the trolley in a suitable work area.
- ✓ Keep the work area clean, uncluttered and ensure there is adequate lighting.
- ✓ Keep the trolley clean and tidy in accordance with good workshop practice.
- x **DO NOT** use the trolley for any purpose other than that for which it is designed.
- x **DO NOT** stand on the trolley, use it as a ladder or allow others to ride on the trolley.
- ✓ Use the wheel locks to prevent the trolley from inadvertently moving.
- x **DO NOT** leave unattended, especially when loaded, unless the wheels are locked, chocked or the trolley otherwise secured.
- x **DO NOT** use trolley on uneven ground and **DO NOT** run over curbs or steps - use a ramp.
- x **DO NOT** use trolley if any part is significantly damaged, paying particular attention to the wheels.
- ✓ Keep children and unauthorised persons away from the work area.



2. DESCRIPTION

Manufactured from high impact polypropylene. This janitorial/housekeeping cart is ideal for storing and transporting a variety of cleaning equipment. Fitted with two sliding shelves and two large vinyl bags. Features multiple broom and mop storage holders on back of unit. Also features a large open top work area with removable compartment tray. Fitted with two large fixed wheels and two lockable castors.

3. TECHNICAL SPECIFICATIONS

Dimensions:.....1146 x 540 x 1000mm

4. CONTENTS

Carefully unpack the product and check the contents against the diagram and parts list below. Should any items be missing or damaged contact your Sealey dealer.

5. ASSEMBLY

Refer to diagram overleaf.

- 5.1. Push the four uprights (9) into the base assembly and insert bolt (1) spring washer (2) and flat washer from underneath, through the wheel and into the base assembly.
- 5.2. Insert the remaining three bolts (1) for each wheel from above, secure with spring washer (2) and a flat washer. Ensure the steerable castors are on the opposite end to the fender bar.
- 5.3. Lower side sections (8) over uprights (9), ensure the raised single edge is uppermost.
- 5.4. Fit the back assembly (17).
- 5.5. Lower the top (10) onto the uprights, make sure the sides (8) and back (17) fit into the recess in it. Screw the top (10) on with screw (13) and washers (11) & (12). Fit plug (14) over each screw.
- 5.6. Slide in shelves (16).
- 5.7. Lay on top organiser (15).
- 5.8. Bolt on the fender bar (5) using nut (7) and washer.
- 5.9. Hook on bags (6).

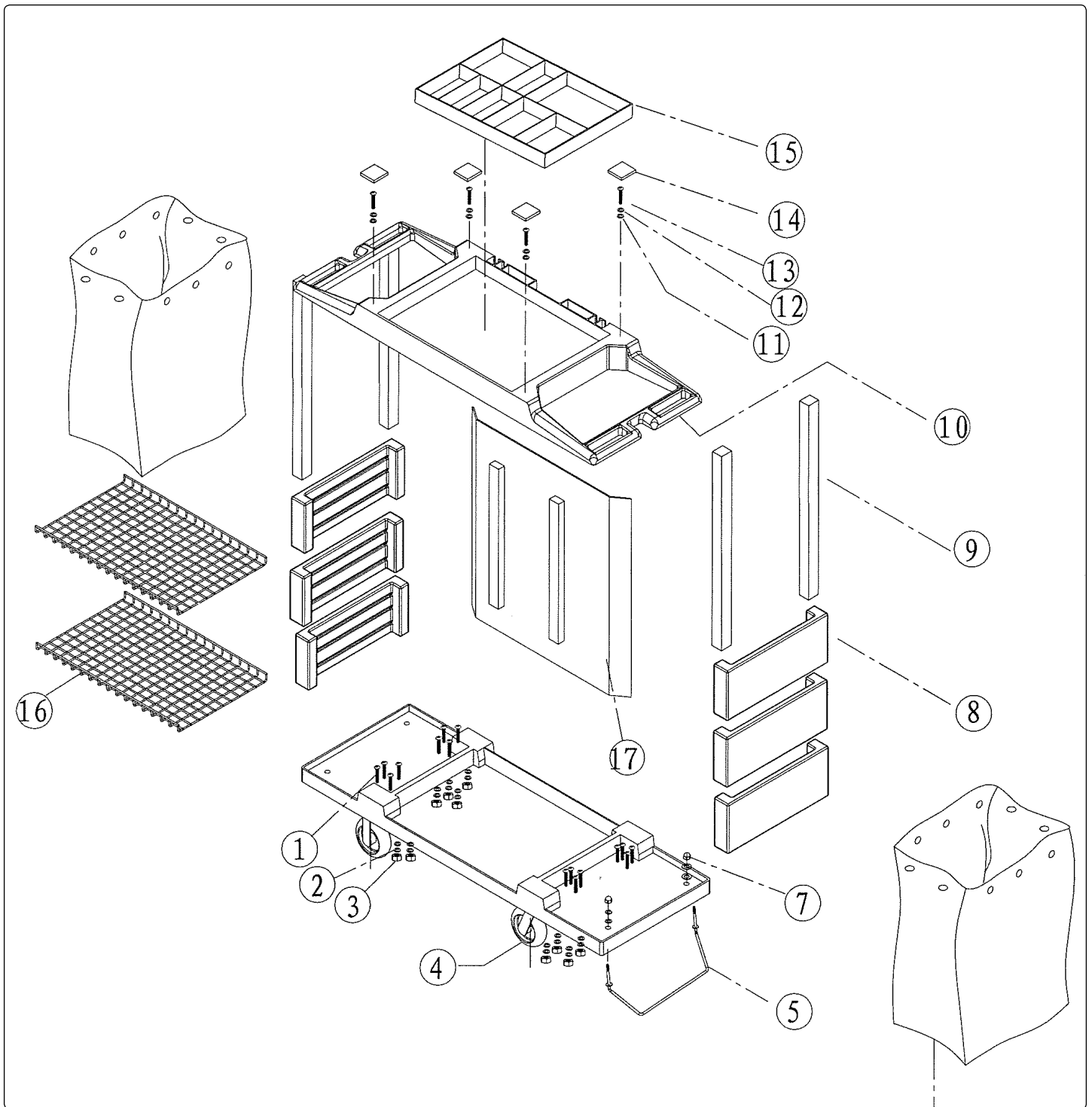

Parts support is available for this product. To obtain a parts listing and/or diagram, please log on to www.sealey.co.uk, email sales@sealey.co.uk or telephone 01284 757500.



Environmental Protection.

Recycle unwanted materials instead of disposing of them as waste. All tools, accessories and packaging should be sorted, taken to a recycling centre and disposed of in a manner which is compatible with the environment.

NOTE: It is our policy to continually improve products and as such we reserve the right to alter data, specifications and component parts without prior notice.

IMPORTANT: No liability is accepted for incorrect use of this product.

WARRANTY: Guarantee is 12 months from purchase date, proof of which will be required for any claim.

INFORMATION: For a copy of our latest catalogue and promotions call us on 01284 757525 and leave your full name and address, including postcode.



Sole UK Distributor, Sealey Group,
Kempson Way, Suffolk Business Park,
Bury St. Edmunds, Suffolk,
IP32 7AR

01284 757500



www.sealey.co.uk

01284 703534



sales@sealey.co.uk